



MODERN SPARE
www.modernspare.com

Storing Your Spare Tire In Your Vehicle

Your Honda Accord, Civic, or Insight will likely have room in the storage space under the trunk floor to place your spare tire. Your kit will include hardware to help secure the spare in place if you ordered the complete **WITHOUT** the optional carrying case.

The following instructions will make storing your spare a simple process.

Before you begin, locate two key items in your kit. You will need the large (24" X 24"), square padding material that came in your shipping box. Also, locate the hardware assembly with a threaded bolt and the large round black washer with two finger holes. See figure below-

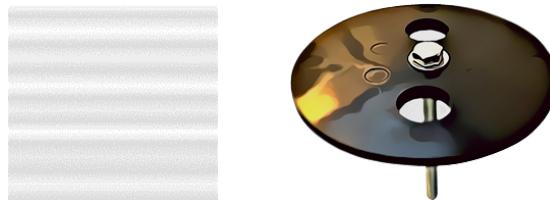

Now follow these steps-

1. Open trunk and lift the floor panel that covers the black or gray foam insert.

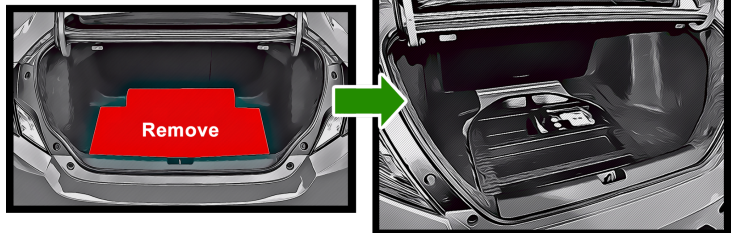

2. Remove the foam insert and set it outside the vehicle.

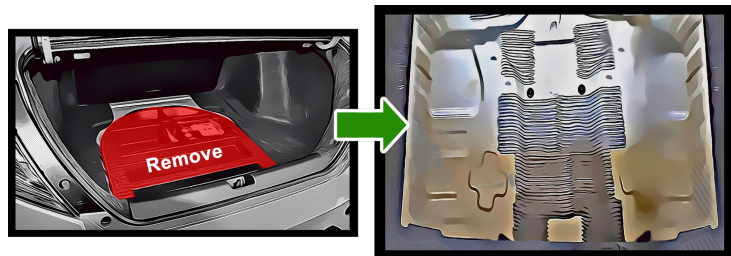

3. Locate and identify the threaded anchor point in the center of the circular storage area.
4. Lay the large square padding material down in the base of the trunk floor.
5. Tear a small hole in the padded material to gain access to the threaded anchor point.

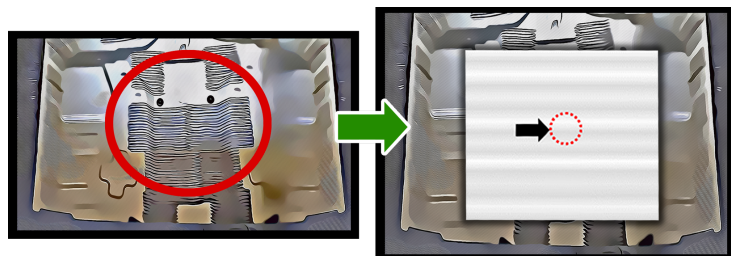



MODERN SPARE
www.modernspare.com

6. Lay the spare tire and wheel combination face down in the trunk well with padded material underneath the spare.
7. Put the threaded hardware assembly through the middle of the wheel so that the bolt will thread into the threaded anchor point.

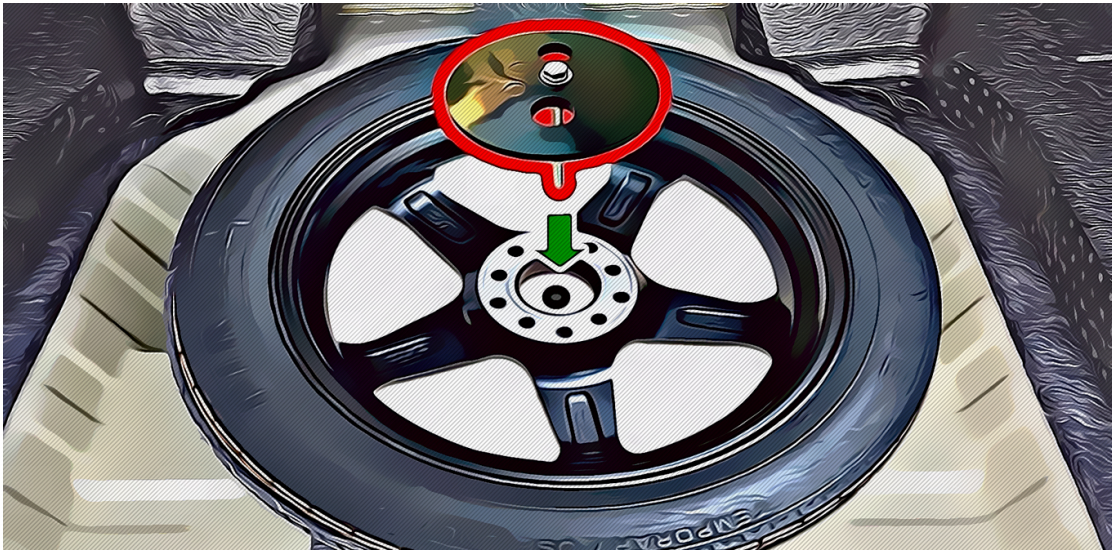

8. Continue to thread the hardware down until the black washer begins to snug down on the wheel hub.
9. Use the finger holes to tighten the assembly snugly against the wheel until you are unable to tighten further.

The remaining items from your kit (jack, wrench set, etc) can be stored alongside the spare in positions that are best for your particular car model.

Some car models may need additional support for the trunk floor panel once this floor panel is back in place. This varies widely by model but Using a 1"-2" thick piece of foam padding can better support the floor panel if the spare does not support the floor as is.